

Included Components

- A. Hardware Packet with instructions
- B. Handblown Glass (QTY:10)
- C. Canopy
- D. Threaded Rod Set with instructions (QTY:2)
- E. Light Body

Required Tools

- 1. Philips screw driver (not included)
- 2. Wire cutters/strippers (not provided)
- 3. Measuring tape (not provided)
- 4. 1/16 Allen Key (provided)

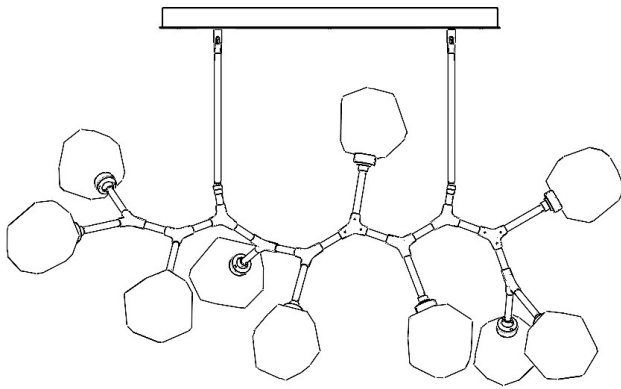

Assembly Instructions

STEP 1: TURN OFF SOURCE POWER TO JUNCTION BOX TO BE USED FOR INSTALLATION.

WARNING:

FAILURE TO USE THE LED DRIVER TO POWER YOUR FIXTURE WILL CAUSE PERMANENT DAMAGE.

STEP 2: Join the two halves of the light body together.

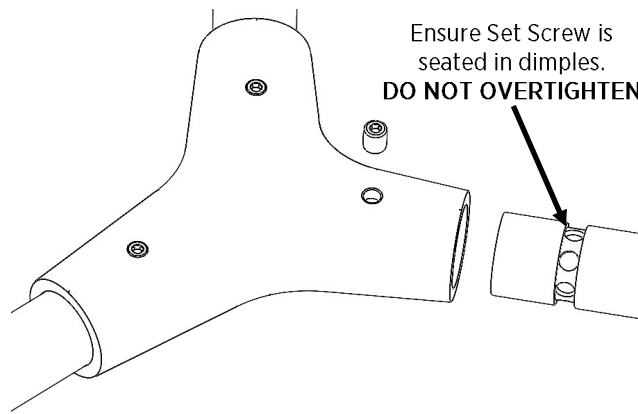
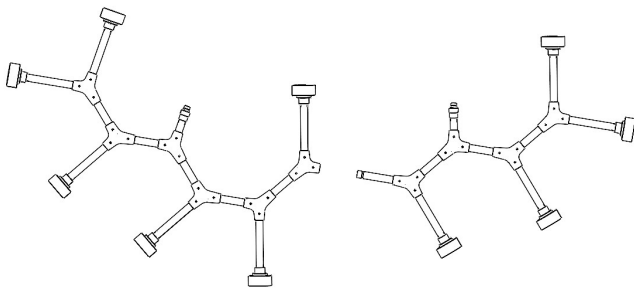

Note: All set screws should be facing the same direction.

STEP 3: Assemble Threaded Rod Set following provided instructions to desired OAH.

Step 4: Carefully feed wires from light body through threaded rods and attach one end to the swivel mounted on the light body. Repeat for other threaded rod set.

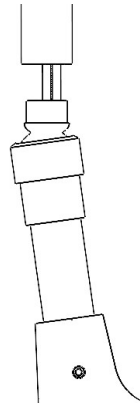

Step 5: Assemble canopy slider with provided washer, nut, IPS, and 90° swivel. Feed wires through and connect to threaded rod. Repeat for other threaded rod set.

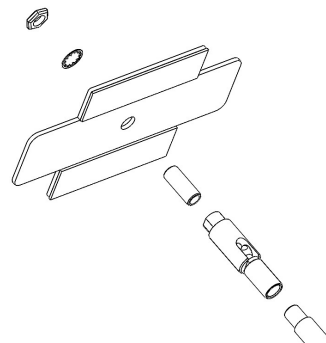

Step 6: Remove canopy faceplates and mount to ceiling following provided mounting instructions.

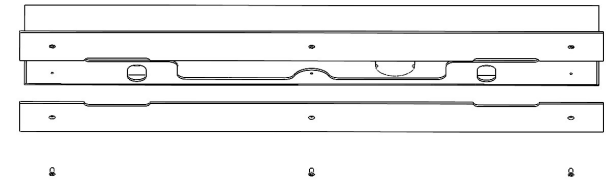

Step 7: Connect drivers to source power. The wires must be connected to the driver, **Black to Black and White to White.**

Step 8: Insert canopy slider assembly into the canopy and slide to the end of the slot. Repeat for other side.

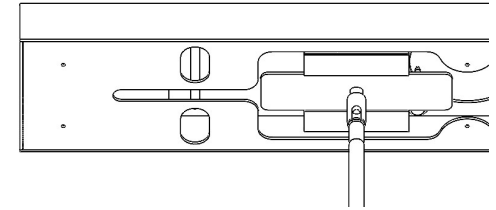

Step 9: Connect the light body wires to the drivers. Plug the male end into the female connector for the 250-42 driver. Wire **Black to Black and Red to Red** on the 500-32 driver.

Step 10: Replace canopy face plates.

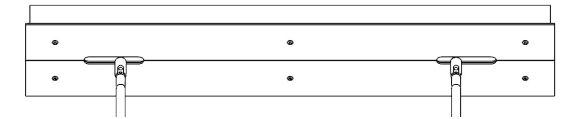

Step 11: Orientation of the light body may be adjusted by using the provided allen key and loosening set screws. Ensure set screw is fully seated when tightening. (see Step 2:)

DO NOT ROTATE 90° PAST ORIGINAL POSITION.

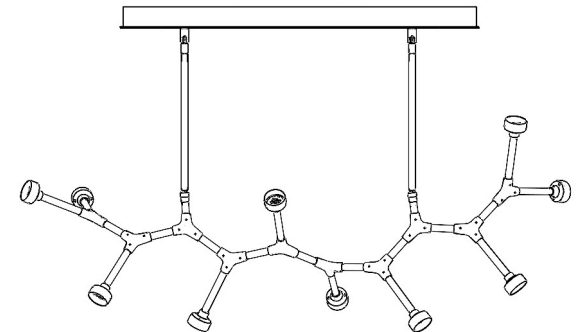

About Hammerton Studio

HAMMERTON STUDIO

When we introduced the Hammerton Studio brand in 2014, we saw an enormous opportunity to raise the bar in decorative lighting. In design, we wanted to lead rather than follow. In construction, we wanted to showcase Hammerton's renowned reverence for time-honored artisan craftsmanship and authentic materials. In performance, we wanted to provide highly reliable solutions that far exceeded industry norms for aesthetics, function, and quality. Based on the brand's dramatic growth and customer feedback, it's clear we are on the right track.

EXTRAORDINARY DESIGN VALUE IN ARTISAN GLASS & METALWORK

Hammerton began in 1995 as a blacksmith shop, but we've come a long way since then. Today we employ a world class team of metal artisans who are disciplined in a broad range of fabrication techniques and processes. We've also added in-house capabilities in blown, cast and kiln-fused glass, and today Hammerton operates one of the largest artisan glass production facilities in the U.S. With deep design and fabrication expertise at the intersection of glass and metalwork, we're laying the foundation for a new era of lighting innovation.

THE HAMMERTON HERITAGE

Our Hammerton Studio brand stands on the shoulders of more than a quarter century of experience pushing the boundaries of innovative custom lighting design. Each Hammerton Studio collection has been inspired by custom work our company has brought to life in collaboration with leading interior design professionals over the years. Built to your specifications, every fixture reflects the uncompromising design and attention to detail that is distinctly Hammerton.

A REPUTATION REFLECTED BY OUR CLIENTS

Hammerton fixtures are as extraordinary as the clients who purchase them, including Forbes 400 members, Fortune 500 leaders, award-winning entertainers, fashion and interior designers, sports legends, and leading luxury hospitality brands.

Hammerton Inc.
217 Wright Brothers Drive
Salt Lake City, UT 84116

801-973-8095 EXT: 4
www.hammerton.com

Warranty

Please visit <https://studio.hammerton.com/lifetime-limited-warranty/> to view the Hammerton Studio Warranty Policy.

Glass

NOTE: Install glass one at a time, ensuring fixture remains balanced. TWO INDIVIDUALS ARE HIGHLY RECOMMENDED FOR GLASS INSTALLATION.

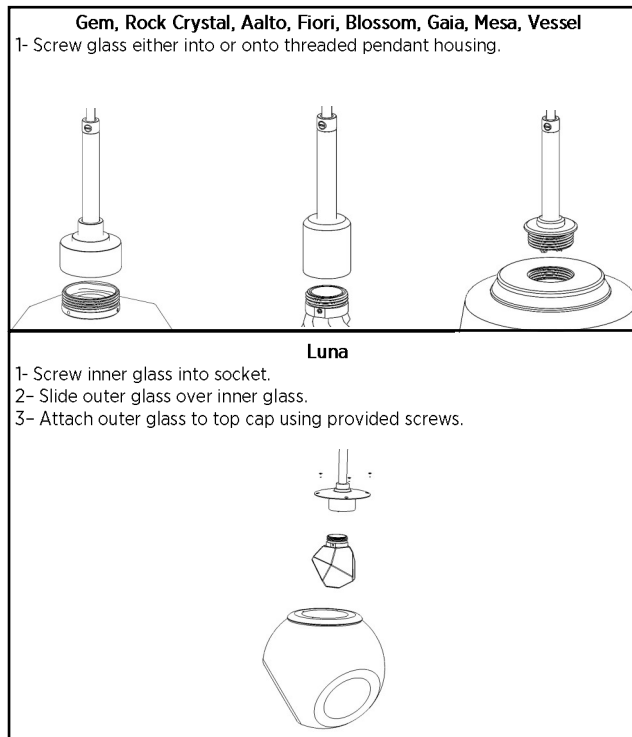

For all Glass Retention

Tighten till snug
DO NOT overtighten

HAMMERTONSTUDIO™

Assembly Instructions 10PC MODERN BRANCH

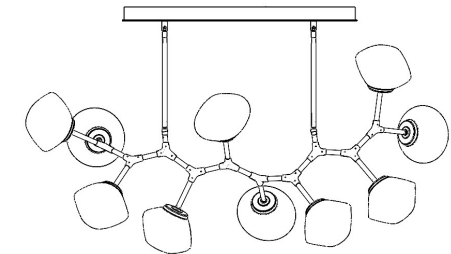
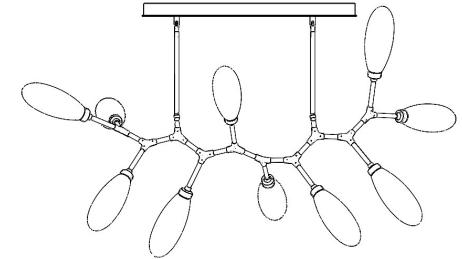
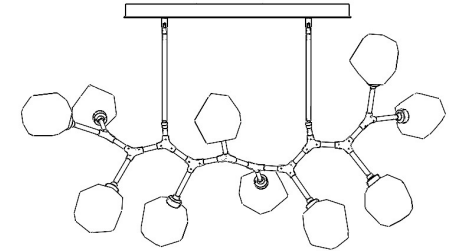

WARNING: FAILURE TO INSTALL THIS FIXTURE PROPERLY MAY RESULT IN SERIOUS PERSONAL INJURY OR DEATH AND PROPERTY DAMAGE.

It is recommended that this product be installed by a licensed electrician.

41-001-00207
Rev 4