

## About Hammerton Studio

---

### HAMMERTON STUDIO

In 2013, the Hammerton Studio brand was created to offer artisan-crafted, contemporary design solutions that are both versatile and accessible. Hammerton Studio fixtures add contemporary distinction to entries, great rooms and master suites, yet are cost-effective enough to use throughout any residential or commercial projects. Like all Hammerton fixtures, they are designed and fabricated in Salt Lake City, Utah using domestically sourced materials.

### POWERFUL DESIGN

Since 1992, Hammerton has been known for extraordinary decorative lighting that is boldly designed, expertly rendered, perfectly proportioned and exquisitely detailed. Each fixture exudes a design aesthetic that is timeless and enduring, yet remarkably relevant.

### UNCOMPROMISING CRAFTSMANSHIP

In addition to their exceptional metalworking and finishing expertise, Hammerton artisans share an aesthetic eye and a sculptural talent that define the difference between ordinary and extraordinary craftsmanship. Every fixture demonstrates its artisan's ability to elevate craft to an art form.

### UNIQUE MATERIALS

Our heritage is in metal fabrication, but our passion is design. As a result—and unlike most of our peers—we work in a broad palette of materials: steel and aluminum, blown, kiln-fired and lampworked glass, acrylics, mica, stone, rawhide, woods and much more. Seamless integration of these capabilities is the "secret sauce" that drives our industry leadership as the premier U.S. based custom lighting manufacturer.

### A REPUTATION REFLECTED BY OUR CLIENTS

Hammerton fixtures are as extraordinary as the clients who purchase them, including Forbes 400 members, Fortune 500 leaders, award-winning entertainers, fashion and interior designers, sports legends, and leading luxury hospitality brands.

Hammerton  
217 Wright Brothers Drive  
Salt Lake City, UT  
84116

801-973-8095  
info@hammerton.com  
www.hammerton.com

## Warranty

---

Please visit:  
<https://studio.hammerton.com/lifetime-limited-warranty/>  
to view the Hammerton Studio Warranty Policy

# HAMMERTONSTUDIO™

## Assembly Instructions SCB0098

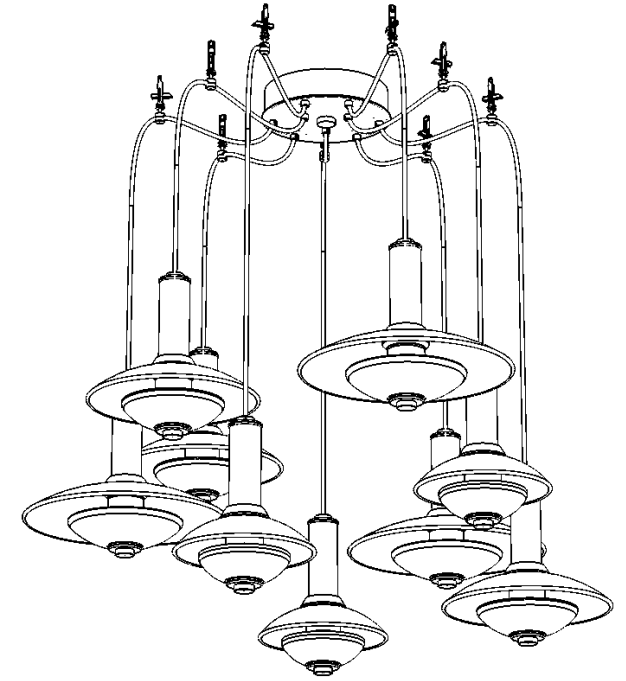

Example: SCB0098-09  
Cirrus 9 PC Swag Multi-Pendant

**WARNING: FAILURE TO INSTALL THIS FIXTURE PROPERLY MAY RESULT IN SERIOUS PERSONAL INJURY OR DEATH AND PROPERTY DAMAGE.**

It is recommended that this product be installed by a licensed electrician who is familiar with proper LED installation and electrical loads.

Rev 2  
41-001-00320

## Included Components

- A. Hardware Packet, with Instructions
- B. Canopy
  - B1. Canopy Faceplate
  - B2. Driver(s)
  - B3. Terminal Block(s)
- C. Pendants
  - C1. Pendant Body
  - C2. Flat Glass
  - C3. Gasket
  - C4. Threaded Ring
  - C5. Foam Spacer
  - C6. Clear Spacer
  - C7. Middle Motif
  - C8. Cast Glass
  - C9. Bottom Motif
- D. Swag Hooks

## Required Tools

1. Philips screw driver (not provided)
2. Wire cutters/strippers (not provided)
3. Measuring tape (not provided)

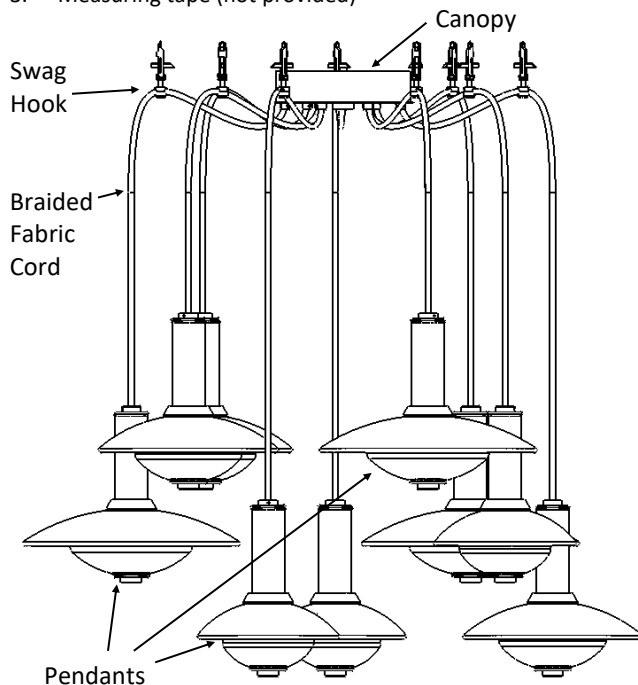

## Assembly Instructions

**Step 1:** Mount the canopy to the ceiling using the provided **Mounting Instructions**. Remove canopy faceplate by unscrewing the flat knob in the center of the faceplate. Make wire connections from source power to LED driver. **WHITE to WHITE** and **BLACK to BLACK**.

**Step 2:** Using the E-Z Toggle Kits (see E-Z Toggle Instructions) included in the Hardware pack, install Swag Hooks radially around where the Canopy will be mounted using a measuring tape to achieve the desired distance.

**Step 3:** Attach each of the pendants to its respective swag hook, adjusting them to their desired height.

**Step 4:** Hold the Canopy in the approximate location it will be installed. Run the cloth cord of each of the pendants one at a time through the canopy faceplate unit it reached the desired sag between the canopy and the swag hook and tighten the cord grip using a flat blade screw driver. The cord grip is on the Faceplate, **DO NOT OVER TIGHTEN. THIS MAY DAMAGE THE FIXTURE.**

**Step 5:** cut cords to length and re-strip the end to prepare for wire connections. Be sure to leave at least 6" of length for wire connections.

## WARNING

### DO NOT DIRECTLY CONNECT LEDs TO AC POWER.

LEDs will be damaged if exposed to high voltages. The LEDs must be wired as described to the included driver to work properly.

**Step 6:** Connect the **PURPLE** (negative) driver wire to the **BLACK** wires from all of the pendants using wire nuts. Connect the **RED** (positive) driver wire to the **WHITE** wires from all of the pendants using wire nuts.

**Step 7:** Install Faceplate onto Canopy and screw Flat Knob onto the IP in the center of the canopy to secure the Faceplate.

**Step 8:** Unscrew the Bottom Motif (C9) from the Pendant Body (C1) and remove the preinstalled Middle Motif (C7), Clear Spacer (C6), and Foam Spacer (C5). Unscrew the Threaded Ring (C4) and remove the Gasket (C3).

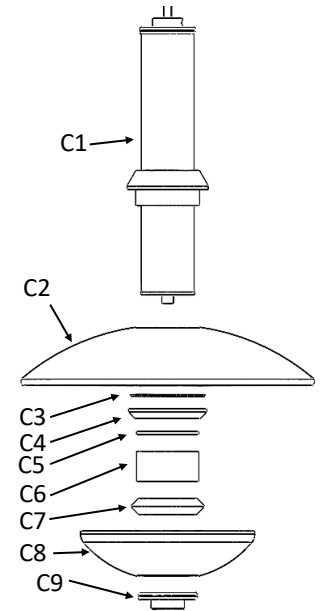

**Step 9:** Slide the Flat Glass (C2) and Gasket (C3) onto the Pendant Body (C1) and secure with the Threaded Ring (C4).

**Step 10:** Slide the black Foam Spacer (C5), Clear Spacer (C6), Middle Motif (C7), and Cast Glass (C8) onto the Pendant Body (C1) and secure with the Bottom Motif (C9).

## NOTE

**The Cast Glass and Flat Glass will be marked with a size (SM, MD, LG). Ensure that on a since pendant there is matching Cast Glass and Flat Glass sizes. LG-LG, SM-SM, etc.**

## E-Z Toggle™ Instructions

Turn E-Z Toggle into drywall until seated flush. Arrows on head indicate direction toggle clamp will open. End with arrows up and down.



Place fixture over E-Z Toggle. Push screw into E-Z Toggle to engage clamp

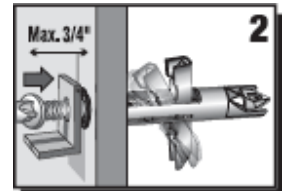

Turn screw until it stops. Toggle clamp tightens against drywall as screw is turned.

