

Included Components

- A. Hardware Packet T, with Instructions
- B. Blown Glass (QTY: 9 or 12)
- C. Ceramic Covers (QTY: 9 or 12)
- D. Canopy
- E. Cloth Braided Cord (QTY: 9 or 12)
- F. Cord grips (Attached to canopy QTY: 9 or 12)
- G. Swag Hooks (QTY: 9 or 12)
- H. Flat Knob

Required Tools

1. Philips screw driver (not provided)
2. Wire cutters/strippers (not provided)
3. Measuring tape (not provided)

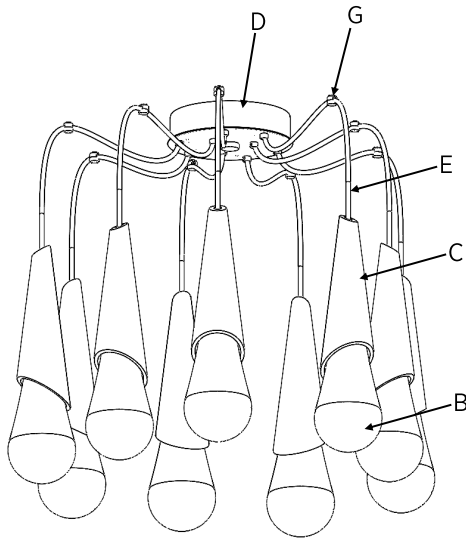

SCB0104-09

Assembly Instructions

Step 1: Remove Canopy Faceplate by unscrewing the Flat Knob in the Center of the Canopy and sliding Faceplate off of IP. Mount the canopy to the ceiling using the provided Mounting Instructions T.

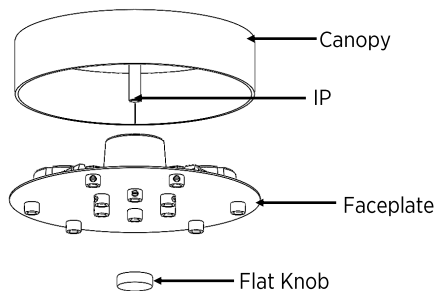

Step 2: Make wire connections from source power to LED drivers. **WHITE** to **WHITE** and **BLACK** to **BLACK**.

Step 3: Using the E-Z Toggle kits (see E-Z Toggle Instructions on the next page) included in the Hardware pack, install Swag Hooks radially around where the Canopy will be mounted. Use a measuring tape to achieve the desired distance from canopy to swag hook.

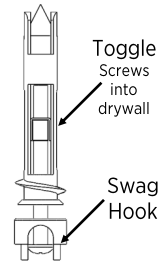

Step 4: Gently run the ceramic covers (C) all the way down all of the cloth braided cords (E).

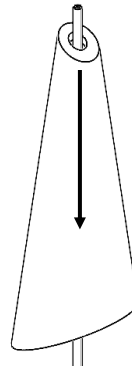

Step 5: Attach each of the pendants to its respective swag hook, adjusting them to their desired height.

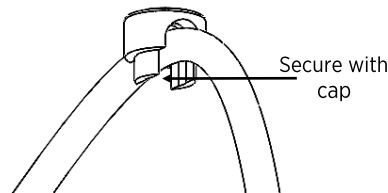

Step 6: Hold the canopy faceplate in the approximate location it will be installed. Run the cloth chord of each of the pendants one at a time through the canopy faceplate until it reaches the desired sag between the canopy and the swag hook and tighten the cord grip on the canopy faceplate using a flat blade screw driver. **DO NOT OVER TIGHTEN. THIS MAY DAMAGE THE FIXTURE.**

Step 7: Cut cords to length and re-strip the ends to prepare for wire connections. Be sure to leave at least 6" of excess wire when you cut the chord to allow enough length for wire connections.

WARNING

DO NOT DIRECTLY CONNECT LEDs TO AC POWER.

LEDs will be damaged if exposed to high voltages. The LED's must be wired in series to work properly.

Step 8: Make wire connections to the driver using the installed terminal blocks. Connect any pendant to any available terminal housing.

DO NOT REMOVE ANY PREINSTALLED WIRES

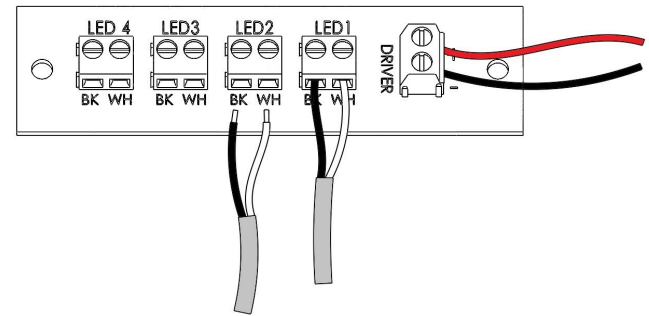

LOOK MAY VARY

WHITE wire to **WH**
BLACK wire to **BK**

Step 9: Install Faceplate onto Canopy and screw Flat knob onto the IP in the center of the Canopy to secure the faceplate.

Step 10: Follow glass installation instructions on the following page.

About Hammerton Studio

HAMMERTON STUDIO

When we introduced the Hammerton Studio brand in 2014, we saw an enormous opportunity to raise the bar in decorative lighting. In design, we wanted to lead rather than follow. In construction, we wanted to showcase Hammerton's renowned reverence for time-honored artisan craftsmanship and authentic materials. In performance, we wanted to provide highly reliable solutions that far exceeded industry norms for aesthetics, function, and quality. Based on the brand's dramatic growth and customer feedback, it's clear we are on the right track.

EXTRAORDINARY DESIGN VALUE IN ARTISAN GLASS & METALWORK

Hammerton began in 1995 as a blacksmith shop, but we've come a long way since then. Today we employ a world class team of metal artisans who are disciplined in a broad range of fabrication techniques and processes. We've also added in-house capabilities in blown, cast and kiln-fused glass, and today Hammerton operates one of the largest artisan glass production facilities in the U.S. With deep design and fabrication expertise at the intersection of glass and metalwork, we're laying the foundation for a new era of lighting innovation.

THE HAMMERTON HERITAGE

Our Hammerton Studio brand stands on the shoulders of more than a quarter century of experience pushing the boundaries of innovative custom lighting design. Each Hammerton Studio collection has been inspired by custom work our company has brought to life in collaboration with leading interior design professionals over the years. Built to your specifications, every fixture reflects the uncompromising design and attention to detail that is distinctly Hammerton.

A REPUTATION REFLECTED BY OUR CLIENTS

Hammerton fixtures are as extraordinary as the clients who purchase them, including Forbes 400 members, Fortune 500 leaders, award-winning entertainers, fashion and interior designers, sports legends, and leading luxury hospitality brands.

Hammerton Inc.
217 Wright Brothers Drive
Salt Lake City, UT 84116

801-973-8095
www.hammerton.com

Warranty

Please visit:
<https://studio.hammerton.com/lifetime-limited-warranty/>
to view the Hammerton Studio Warranty Policy

HAMMERTONSTUDIO™

Assembly Instructions

SCB0104-09, SCB0104-12

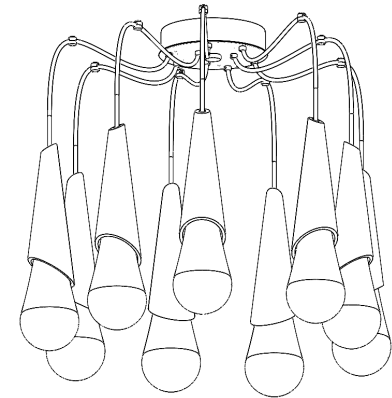

SCB0104-09

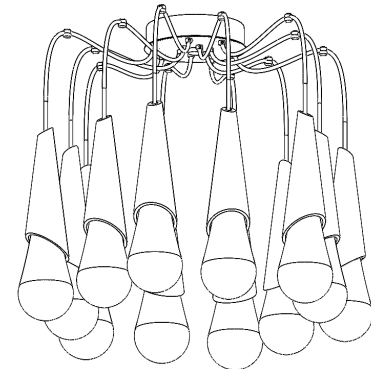

SCB0104-12

**WARNING: FAILURE TO INSTALL THIS
FIXTURE PROPERLY MAY RESULT IN
SERIOUS PERSONAL INJURY OR DEATH
AND PROPERTY DAMAGE.**

It is recommended that this product be installed
by a licensed electrician who is familiar with
proper LED installation and electrical loads.

41-001-00334
Rev 2

Prior to installing glass ensure all cords are properly secured through each swag hook so the glass is being supported by the swag hook and not the canopy. Solely supporting by the canopy may overload the J-Box mount resulting in damage.

Raindrop Glass Install

Step 1: Place acrylic diffuser inside glass. (Note: diffuser may have a white protective film. Remove this prior to install)

Step 2: Raise Ceramic Cover

Step 3: Screw glass onto threaded housing

Step 4: Lower Ceramic Cover onto glass so that the foam collar folds over the glass.

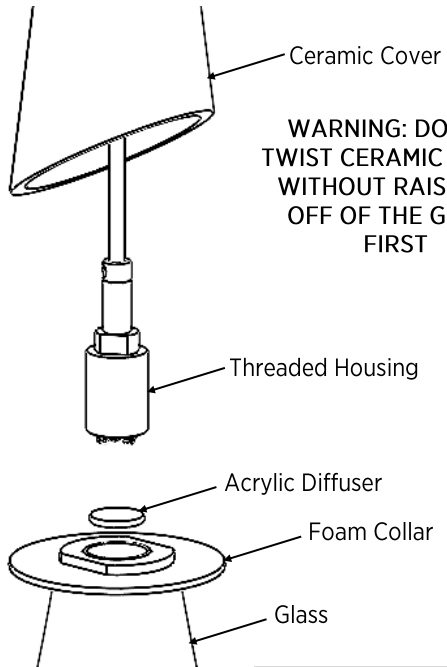

E-Z Toggle™ Instructions

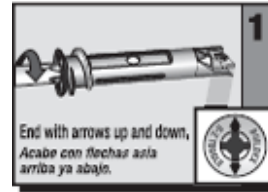

Turn E-Z Toggle into drywall until seated flush. Arrows on head indicate direction toggle clamp will open. End with arrows up and down.

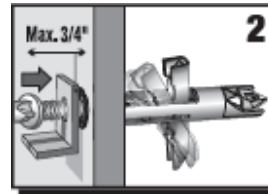

Place fixture over E-Z Toggle. Push screw into E-Z Toggle to engage clamp

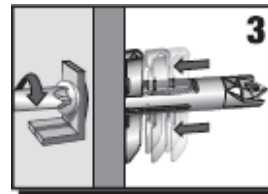

Turn screw until it stops. Toggle clamp tightens against drywall as screw is turned.